

KEY:

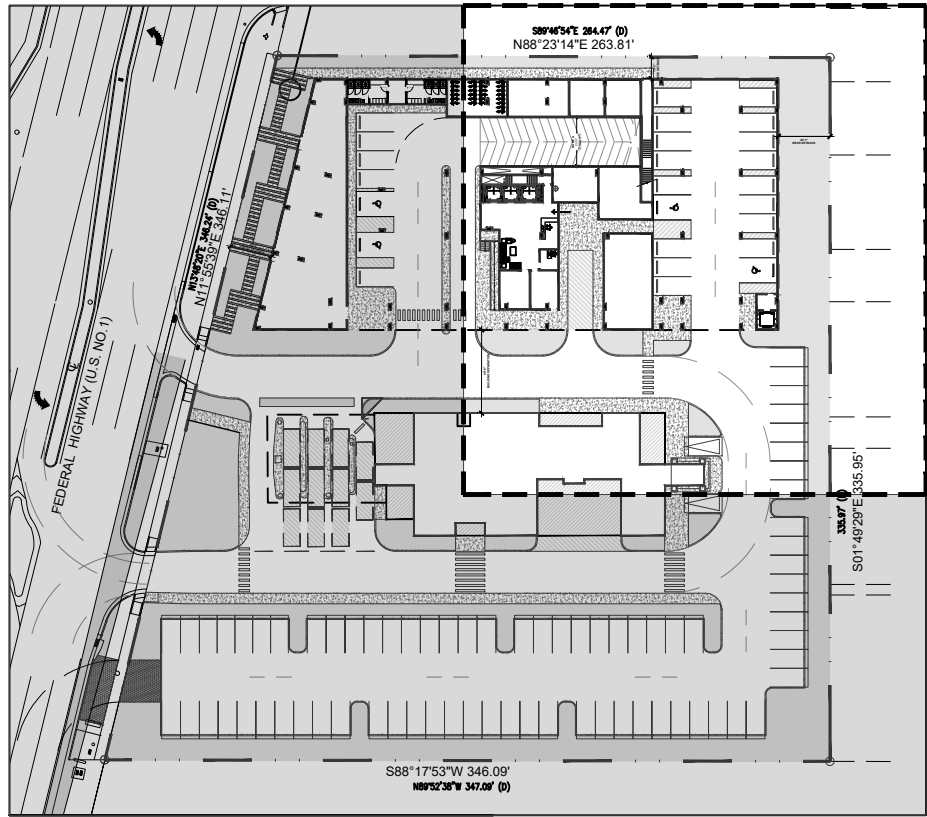

HARDSCAPE SCHEDULE					
KEY	DESCRIPTION	MANUFACTURER	COLOR	FINISH	SIZE
1	Concrete	Contractor	Grey	Standard	See civil
2	Concrete Paver	TBD	TBD	TBD	TBD



absolute-idea.com
CANAL PARK
3323 NE 163rd Street, Suite 200 North Miami Beach, FL 33160
305.792.0015 305.931.0279 info@absolute-idea.com

SEAL
KEN GARDNER
FLA 1589
TO THE BEST OF MY KNOWLEDGE, THE PLANS AND SPECIFICATIONS COMPLY WITH THE CITY OF MIAMI BUILDING CODE AND THE APPLICABLE PROFESSIONAL STANDARDS AND REQUIREMENTS OF THE STATE OF FLORIDA AS ACCORDANCE WITH THE SECTIONS HEREIN IS REQUIRED.

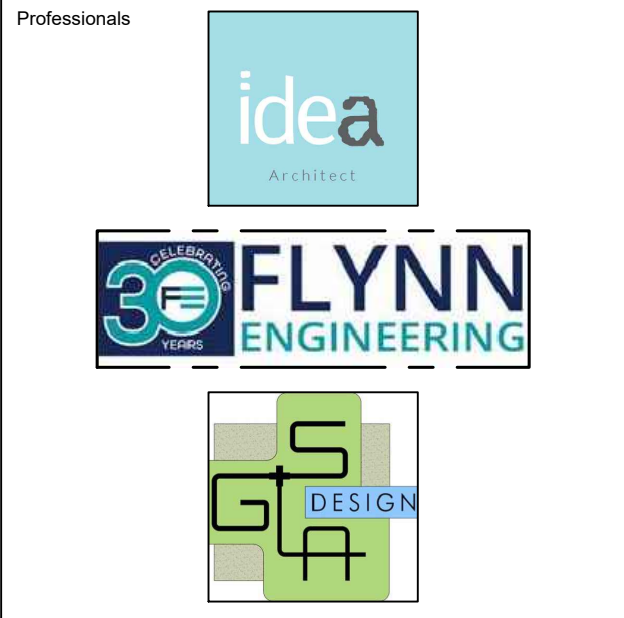

REV.	DATE	DESCRIPTION
01	XX-XX-2024	D.R.C. SUBMITTAL

ALL MEASUREMENTS MUST BE VERIFIED BEFORE BEGINNING THE WORKS. NO MEASUREMENTS ARE TO BE SCALED DIRECTLY FROM THIS DRAWING.

Key section
PROGRESS SET

Client
VERA FUND
NICK POLYUSHKIN
& YURI KHARITONENKOV
TEL: 305.833.3303

Project
**1600 S FEDERAL HIGHWAY
(MIXED-USE PROJECT)**
1600 SOUTH FEDERAL HIGHWAY,
POMPANO BEACH, FL 33062

Title	
HARDSCAPE PLAN GROUND FLOOR	
Drawn GSLA	Field LANDSCAPE ARCH
Verified KG	Scale as shown
Approved KG	Date 10-09-2024
Project Manager KG	Dwg. no. L-102
Project 24-838	

